



South Coast ORCHID Society, Inc.

LONG BEACH, CALIFORNIA

Meets on the 4th Monday of each Month at Silverado Park Club House, 31st Street and Santa Fe Ave.

Orchids are gracious living - wear them.

CHARLES E. BOWMAN
PRESIDENT

GEORGE M. HUDSON
1ST VICE PRESIDENT

J. L. THRESH
2ND VICE PRESIDENT

MRS. GLENN W. HAMILTON
SECRETARY

ROLAN R. HOWARD
TREASURER

WOODROW C. WILSON
MEMBERSHIP SECRETARY

VAN D. TILTON
ADVERTISING MANAGER

LEE N. BENTZEN
BULLETIN EDITOR

PROGRAM - MARCH 24, 1958 - - - 8:00 PM

**MRS. H. W. CROTHERS WILL SPEAK ON
"SPECIES AND US"**

X
A year and a half ago the Crothers, with their collection of some 600 plants, moved from Yakima, Washington to Vista, California. Today they live in a garden paradise, enjoying life with an outstanding collection of specie and hybrid orchids, and adding to it, as the opportunities present themselves, with fine varieties. Mrs. Crothers has a wealth of knowledge and experience in the collecting and propagating of orchids, and particularly the species. She will supplement her talk with her own slides, so this promises to be a program you'll long remember.

The speaker will start promptly at 8:15 P.M.

REFRESHMENTS

Our thanks to Mrs. Harry Rapella and Nell Howard for serving refreshments last month. The table decorations, carrying out the George Washington Cherry tree motif, were most appropriate, and created a most delightful conversation piece. At this months meeting Mrs. Albert R. O'Stephenson and her committee will serve refreshments during the social hour, with a St. Patrick's Day theme.

BANQUET PHOTOS

Banquet photographs, ordered during the last meeting, are now ready and will be available at the next meeting.

PLANT FORUM

The Plant Forum, under the able direction of Joe Hampton, has been glamorized. The four tables, identified by generas, with signs, is a definite improvement and facilitates conducting of the program. Mrs. H. W. Crothers presented the Botanicals and Species, Ernest Hetherington the Cymbidiums, Clark Day the Cypripediums, and Joe Hampton the Cattleyas. Some 67 plants were on the tables for commentary. Bring in your blooming plants for others to enjoy, and remember, there is a special drawing for contributors.

PLANT DRAWING

This months plant drawing will contain some very fine Specie orchids, in keeping with the subject of the meeting, as well as some very fine Cattleya hybrids. These have been procured from the range of "Doc" Charles in Costa Mesa. "Doc" Charles has just returned from a collecting trip in Mexico where he acquired some very fine specimen and rare plants. Some of these jungle collected species will be included in the drawing. This is an excellent

DUES

Again we remind you that the 1958 Society dues should be remitted as soon as possible. The Membership List is ready to go to press, and we'd like to include all members.

Dues are \$8.00, including subscription to the Orchid Digest. Society dues alone are \$4.00. Please remit your dues to the Membership Secretary, Woodrow C. Wilson, 2453 Flower Street, Huntington Park, or contact him at the next meeting.

MEMBERSHIP DRIVE

The Membership Drive is underway !!

We know that there are many folks interested in orchids, who are not aware of our Society, or have not been encouraged to attend a meeting. These could be friends of yours. Invite them out to learn for themselves that there are educational and social benefits to be gained through membership in our organization. Bring a friend and make a member. As an added inducement, each new member and his sponsor will be given an orchid plant.

NOVICE CLASS

The last Novice Class, attended by 40 members and guests, met at the home of Mr. and Mrs. Harry Lincoln, to whom we say "Thank You" again. The meeting opened with coffee and donuts, after which a general discussion was held on the subject of orchid problems and Cymbidium potting and culture. This led into a most enlightning discussion on de-mineralized water, with J.L. Thresh, Chairman, displaying his water unit, which he built himself. He quite thoroughly explained its construction and volunteered to provide plans for its assembly at the next meeting.

Because of Easter Sunday, the next meeting will be held on the second Sunday of the month, April 13th, and will be held at the home of Mr. and Mrs. Woodrow C. Wilson, 2453 Flower Street, Huntington Park- Phone LU 5-3082, at 10:00 A.M. We welcome you to join this friendly group, and bring your orchid problems with you. The map below shows the way to the Wilson's.

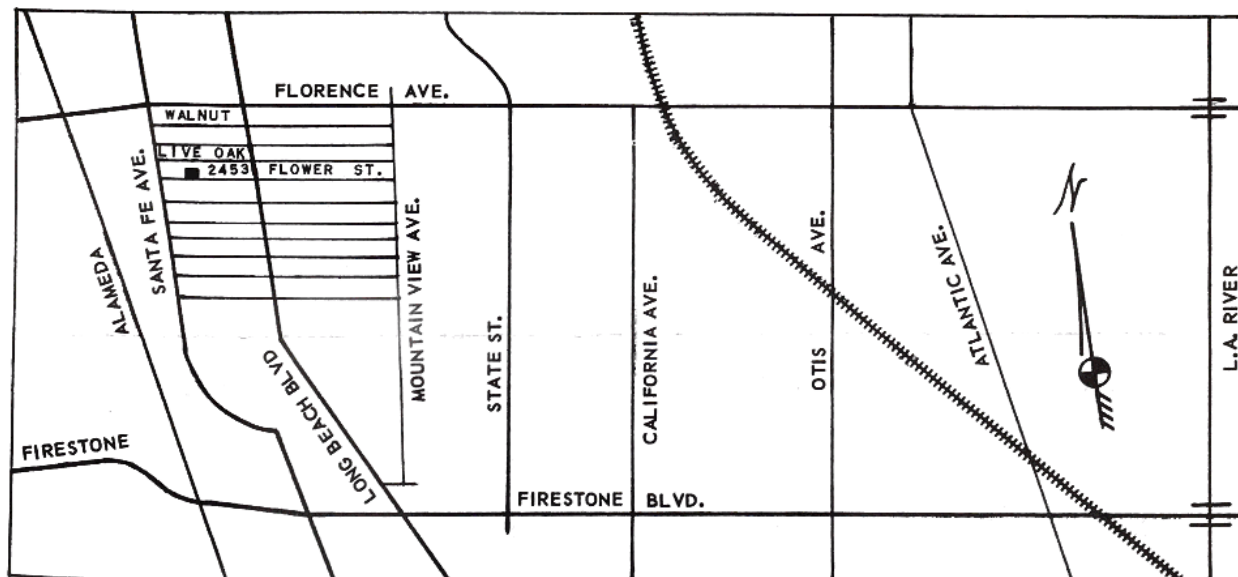

CORSAGE CLASS

The Corsage Class meets on the first Monday of each month. The next class will meet April 7th at 7:30 P.M. at the home of Mr. and Mrs. Harry Lincoln, 3521 Sanborn Ave., Lynwood. Mrs. Dowling is the instructor, and there is a charge of \$1.00 per person plus cost of materials.

March 29 and 30 - 12th Annual Orchid Show, San Diego County Orchid Society
Conference Hall, Balboa Park.
April 17 - 20 - 6th Annual Western Orchid Congress
Rickey's Studio Inn, Palo Alto, California
April 24 - 27 - Santa Barbara Cymbidium Show
Santa Barbara, California.

A bus trip has been arranged for the San Diego County Orchid Society show. Our Society has chartered a bus and plans to make an outing of it on Sunday, March 30th (Not Saturday, as previously stated). The bus will pick up the group at 8:30 A.M. in back of the May Company, Lakewood, (East side). On the way down, we will stop in Carlsbad to visit the orchid range of Albert R. Stephenson, 2478 Fire Mountain Drive; then on to the Orchid Show. A special price of 75¢ per person has been arranged for the group as entry fee to the show. The round trip bus fare is \$3.25 each. Rolan Howard, 13708 Cordary, Hawthorne, Phone OS 5-1006, is in charge of the bus trip, and we urge you to get your reservations in to him quickly.

A bus trip is also being arranged for the Santa Barbara Cymbidium Show on Sunday, April 27th. The round trip fare will be \$3.25 per person, and will include a side trip to the Dos Pueblos Orchid Range at Goleta. This should be another very interesting trip, so start making your plans. Rolan Howard will be handling the arrangements and we'll have more information later.

ADVERTISING

For information relative to advertising space and rates in the Bulletin, see, write or call Van D. Tilton, our Advertising Manager. His address is 3854 Clark Ave., Long Beach 8, and telephone GA 5-8306. Deadline for each months issue is the second Friday of the month.

NEW MEMBERS

The following are new members in our Society - Look them up at the next meeting.

William G. Braid, 1580 Ramillo Ave., Long Beach 15

Brainard Ferguson, 3354 Charlemagne, Long Beach

Mr. and Mrs. L. A. Walters, 9422 Broadway, Temple City

Mr. and Mrs. Leonard L. Weber, 104 Highland Ave., Manhattan Beach

Please enter their names on your membership list for future reference.

GUESTS

(FEBRUARY MEETING)

The following were guests at our February meeting. We sincerely hope for a return visit from them.

Robert M. Sopp, Manhattan Beach

Mr. and Mrs. Frank Fordyce, Covina

Mr. and Mrs. Ward Coburn, Westminster

Mr. and Mrs. Philip Ilsley, Beverly Hills

Ed Rucker, San Pedro

Margaret Barker, Paramount

Mr. and Mrs. Lee Early, West Covina

Mr. and Mrs. E. A. Pennington, South Gate

JUDGING

South Coast Orchid Society and Orchid Digest Corporation judging commences at 7:00 P.M. Plants not in the Judging Room by that time cannot be judged. Fill out your entry form completely and legibly, as all information requested is required for the records. Have a varietal name selected for your plant and enter it on the judging form.

SOUTH COAST AND ORCHID DIGEST REGIONAL JUDGING

February 24, 1958

Judging Chairman: Glenn W. Hamilton
 Judges Present: Dorothy Holmquist, Morris Holmquist, George Field, Ernest Hetherington,
 Joseph Hampton, Nell Howard, Rolan Howard, Arthur Falk, Howard Anderson
 Assoc. Judges Present: Cleda Lincoln, Jean Field, Woodrow Wilson, Leo Holquin, Albert Stephenson

Twenty-Six Plants were entered for judging of which the following ten received awards.

Award No.

- 140 Cym. Lillian Stewart "Dusty Rose", H.C.C., 75 points. Shown by F. A. Stewart.
A stem of nine deep shaded pink flowers with a natural spread of 4 inches.
- 141 Cym. Lillian Stewart "Delicata", H.C.C., 77.2 points. Shown by F. A. Stewart.
Fifteen white flowers with pink shading, having a natural spread of 4½ inches.
- 142 Cym. San Francisco "Amber Green", H.C.C. 77.2 points. Shown by F. A. Stewart.
Eleven light green flowers with brown and maroon shading. Natural spread 4½ inches.
- 143 Cym. San Francisco "Embarkadero", H.C.C. 78.5 points. Shown by F. A. Stewart.
Eleven rich gold blossoms tinged bronze. Natural spread 4½ inches.
- 144 Cym. San Francisco "Fan Fare", H.C.C. 76.1 points. Shown by F. A. Stewart.
Nine rose pink maroon shaded flowers with a natural spread of 4 inches.
- 145 Lc. Grace Hecker "Jacobin", H.C.C. 75.8 points. Shown by Earl Monson.
*Three rose lavender flowers with a deep maroon lip showing small gold eyes.
 Natural spread 5½ inches.*
- 146 C. Los Gatos "Angora", H.C.C. 75.5 points. Shown by Arthur Falk.
*Two heavy white flowers with overlapping petals and clear yellow in throat.
 Natural spread 5½ inches.*
- 147 Lc. Bonanza "Crown Jewel" H.C.C. 75 points. Shown by A. R. Stephenson.
*Two overall rose lavender flowers with deeply ruffled petals and a dark maroon lip.
 Rich gold eyes and veining in throat. Natural spread 6 inches.*
- 148 C. Los Gatos "Sunny Hills", H.C.C. 77.3 points. Shown by Arthur Falk.
Two clear white flowers with deep gold veining in throat. Natural spread 6½ inches.
- 149 C. Ava Maria "Hallelujah", H.C.C. 76.3 points. Shown by Toy's Orchids.
*Three clear white flowers with a ruffled lip and deep gold in throat.
 Natural spread 7 inches.*

F.C.C.	First Class Certificate	90 to 100 Points
A.M.	Award of Merit	80 to 89.9 Points
H.C.C.	High Class Certificate	75 to 79.9 Points

A LETTER

Glen Hamilton is in receipt of a letter from a Mr. Johnson in Mexico who has a collection of some 2,000 plants, representing 150 species, collected from the "wild". He states some very good species are developing seed pods and will be maturing soon. Any Society member interested in acquiring seed is invited to write him. Following is his list of available seed. From those marked with an asterisk, he would desire some seedlings in return; the others are available for the asking. Address correspondence to: John M. Johnson, Apartado 79, San Miguel Allende, GTO, Mexico.

Lycaste virginalis (L. Skinneri)
 **Stanhopea oculata x Wardii (crossed out of curiosity)*
Odontoglossum Insleayi (type)
 **Odontoglossum Insleayi var. aureum (beautiful and rare)*
Laelia anceps (very dark coloring)
 **Laelia anceps alba (I have a good supply of this fine white)*
Laelia anceps (very pale)
Laelia anceps (large, rich coloring)

**Laelia autumnalis, alba (beautiful, hard-to-come-by)*
Laelia autumnalis var. atrorubens
Laelia rubescens (white, with purple throat)
 **Laelia superbiens*
Brassavola nodosa
Brassavola cucullata
Epidendrum alatum (one of my favorite "Mexicans")
Epidendrum nemorale

Ruth Hamilton, Secretary
 2510 Palm Drive
 Long Beach 6, California

You are invited

open house - PRE-EASTER FLOWER SHOW
and ORCHID PLANT SALE

SATURDAY and SUNDAY
MARCH 29th and 30th 1958
9:30 A.M. to 4:30 P.M.

Armacost & Royston, Inc.

11910 LA GRANGE AVE., (Near Bundy Dr.) WEST LOS ANGELES, CALIFORNIA

On March 22-23

YOU WILL SEE THE MOST BEAUTIFUL DISPLAY OF CYMBIDIUMS YOU HAVE EVER SEEN!

Fred A. Stewart, Inc. invites you to

Open House

Saturday, March 22 9:00 - 5:00 Sunday, March 23 10:00 - 5:00

Our complete staff will welcome you as you enjoy the display of Cymbidiums, Cattleyas, Cypripediums, and botanicals, all arranged for your pleasure on this very special occasion.

Bring your friends. Come and enjoy yourselves. People like to visit Stewarts - where there's always something exciting to see.

Here are a few of the special features . . .
Special educational displays Discount groups of seedlings
Free gifts Refreshments
Special Open House prices

Fred A. Stewart, Inc.

8606 E. Las Tunas Drive

At 7-8974

San Gabriel, Calif.

FOR THE FIRST TIME

DEIONIZERS FOR THE ORCHID GROWER
AT PRICES YOU CAN AFFORD

- DESIGNED ESPECIALLY FOR THE GROWER.
- MADE IN SIZES FOR THE AMATEUR AS WELL AS THE COMMERCIAL GROWER.
- RUGGED CONSTRUCTION FOR LONG LIFE.
- SIMPLEST REGENERATION PROCEDURE POSSIBLE.
- CARMA SINGLE CONTROL MULTI-PORT VALVE.
- TERMS AVAILABLE.

CARMA MFG. CO.

1879 MULLIN AVENUE
TORRANCE, CALIFORNIA
FA 8-7536 NE 6-5757

JUST ARRIVED

JUNGLE ORCHID PLANTS

FLOWERING SIZE PLANTS
\$1.00 EACH

ANOTHER SHIPMENT
OF \$1.00 SIZE PLANTS
DUE MARCH 29th

FRICKER ORCHIDS

5248 E. SERENO DR., TEMPLE CITY
ATlantic 6-8704

1 1/2 MILES NORTH OF SAN BERNARDINO FREEWAY
ON ROSEMEAD

South Coast Orchid Society, Inc.
Bulletin

ADVERTISING RATES

Full Page	-	\$30.00
Half Page	-	15.00
Quarter Page	-	7.50
Eighth Page	-	4.00
1/16 Page	-	2.00
1/32 Page	-	1.00

ADVERTISING MANAGER

VAN D. TILTON
3854 Clark Ave., Long Beach 8
HA 5-8306

THE PERFECT NEW POTTING MEDIUM SILVACON® DOUGLAS FIR BARK



THE PERFECT MEDIUM FOR ALL GENERAL PURPOSE POTTING.
SILVACON® IS CLEAN WOOD-FREE FIR BARK—NO CHEMICALS HAVE BEEN ADDED.

CHECK THESE REASONS WHY ORCHIDISTS PREFER SILVACON® DOUGLAS FIR BARK

- Saves labor & material costs
- Produces better blooms
- Provides natural aeration
- Speeds up potting time
- Promotes stronger roots
- Improves growth rate



Magnified view showing strong extensive root system typical of plants potted in Silvacon 00.

Packed in 50 lb. 2 cu. ft. polyethylene lined bags. Two sizes, #00 for adult plants and #383 for seedlings. Immediate delivery.

PRICES PER BAG

5 bags or less	6 to 10 bags	11 to 25 bags	26 to 100 bags
\$2.50	\$2.25	\$2.00	\$1.75

F.O.B. OUR LOS ANGELES WAREHOUSE

SINCE THE TRUCK SHIPPING COSTS ARE BASED ON A 100 LB MINIMUM, WE CAN SHIP TWO BAGS FOR THE SAME COST AS ONE BAG.

RHEINFRANK & ASSOCIATES

5414 Sierra Vista Ave.

Los Angeles 38, Calif. — phone HOLLYWOOD 5-2578

POTTERS ORCHIDS & SUPPLIES

Orchid Fertilizers

FORMULA 3-1-2

1 lb. \$1.00—3 lbs. \$2.50—25 lbs. \$15.00

INSTANT VIGORO

1 lb. \$1.25—3 lbs. \$3.00—25 lbs. \$13.35

ORCHID SPOONIT 30-10-10

1 lb. \$1.25—2½ lbs. \$2.50—10 lbs. \$8.00
25 lbs. \$16.00

Insecticides

WILSON'S SUPERCIDE—Pint \$1.95

Fungicides

WILSON'S ANTI-DAMP—Pint \$1.75

Slug & Snail Bait

COOKE'S SLUG-N-SNAIL (dust)

8 oz. \$.85—2½ lbs. \$2.79—15 lbs. \$14.25

SLUGIT (liquid)—8 oz. \$1.50

Specialties

VITA BARK (2 cu. ft. bags)—\$2.00

HYDROMIX UNIT—\$3.95

WIRE POT HANGERS—each \$.15

\$12.00 per 100

"400" WATER BREAKER—\$1.50

WIL-MAC. DUSTER

Model RO—Capacity 2 lbs.—\$13.95

Model MO—Capacity 7 oz.—\$8.95

These dusters are hand crank dusters of cast aluminum, of high air velocity.

F.O.B. GARDEN GROVE

12372 Stanton Ave. (Highway 39)

Garden Grove, Calif. LEhigh 95290

TRUE FEEDING ECONOMY!

Wilson's NEW

20-20-20 ORCHID FERTILIZER

Now you can feed your orchids with a 100% water soluble fertilizer, complete with all needed TRACE ELEMENTS, for less than ¼¢ per gallon. A 2 lb. can makes over 2100 gallons of finished nutrient. Compare formula and finished cost with other orchid fertilizers.

Two feeding ratios,
one for osmunda or fir bark, another
for gravel culture.

2 lb. can \$4.85

25% discount for case of 12

We prepay shipping charges if remittance plus applicable sales tax accompanies order.



HOOF & HORN

25 lb. \$4.00

The perfect additive

50 lb. \$6.00

for Fir Bark

100 lbs. \$11.25

RHEINFRANK & ASSOCIATES

5414 Sierra Vista Ave.

Los Angeles 38, Calif. — Phone HOLLYWOOD 5-2578

Don't forget the membership drive!

Bring a FRIEND TO THE NEXT MEETING

A free plant to each new member and sponsor

SOUTH COAST ORCHID SOCIETY, INC.
Silverado Park Club House

seed sowing

PROMPT ATTENTION — REASONABLE RATES

G. W. HAMILTON

2510 PALM DRIVE, SIGNAL HILL 6, GA 7-0897

DEADLINE DATE FOR ADDS

SECOND FRIDAY OF EACH MONTH

Van D. Tilton

3854 Clark Ave., Long Beach 8, HA 5-8306

VITA FIR BARK

\$2.00 PER BAG

SPECIAL SALE ON

BC. LINDA SUSAN

7" Pots \$7.50 each

6" Pots 5.00 each

5" Pots 3.00 each

RAPELLA ORCHIDS

13518 Yukon Ave.

OSborne 6-1681

Hawthorne, Calif.

SCOS MEMBERS!

SUPPORT YOUR BULLETIN ADVERTISERS

Inserted into the copy at The Huntington in the "orchid archive" is what looks like an outline for the presentation given at this meeting by Mrs. H. W. Crothers:

- 1 how we became interested in orchids, Uphill when you know nothing about them except that there is such a thing.
- 2 A couple of books - found out about A.O.S. and joined it.
- 3 Visited Seattle and joined the society - educational to attend meetings. Their forum handled differently than here.
- 4 got some bulletins and began to learn, visited other growers
- 5 started sending for catalogues of anything that caught our eye
- 6 went to Society meetings and shows, but soon found out that many things we wanted to know about we would have to grow and flower ever to see.
- 7 a trip to Hawaii
- 8 a move to another home, bigger greenhouse but poorer water river water not bad - well water terrible.
- 9 Learn to SEE your plants, growing instructions - ? ? ? ??
- 10 show slides.

1

To begin, we will go back to 1950. We were living in central Washington State, in a farming community where the climate was hot in summer, cold in winter and dry all the time.